

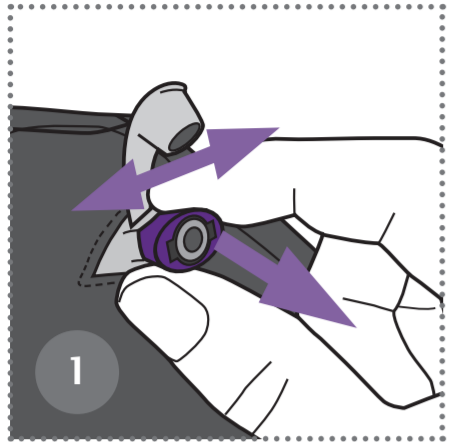

How to Use



Pull the valve ring upwards. Move it to the side until the vacuum cushion becomes soft.



Stroke the fabric liner smooth to distribute the small spheres evenly.



Pull the fabric liner upwards.
Position the foot at the very back of the lower shell.



Fit the upper shell

Correct position of the upper shell:
In the area of straps 3: inside the lower shell.
In the area of straps 4: outside of the lower shell.
Close straps in the order 1-2-3-4.

Warning:
The valve must not be kinked or covered by the upper shell.

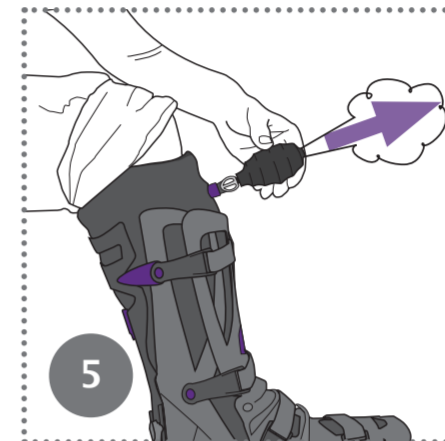

Adjust vacuum cushion
Push the valve ring downwards.
Attach the suction pump.
Squeeze the suction pump until it no longer inflates.
Close the valve cap.

Change Sole/ Adjust Sole Length

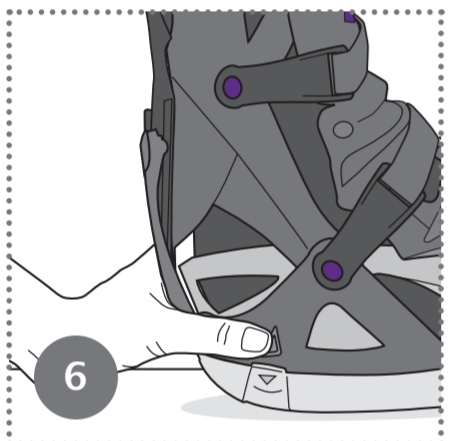

Push both unlocking buttons simultaneously and remove sole. (Fig. 6+7)

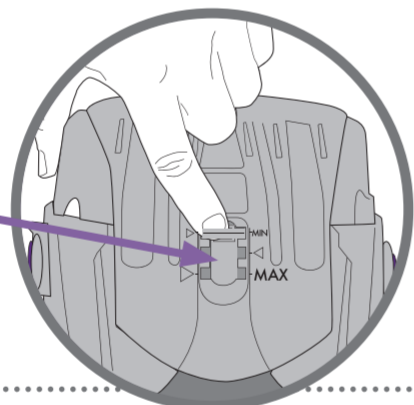
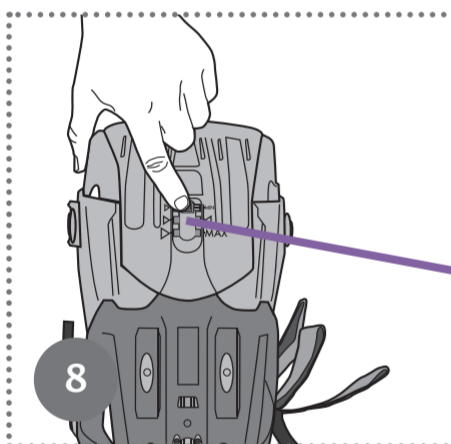

Push the unlocking button. (Fig. 8)
Pull toe section to the desired length.
Insert sole again.

Guideline Value for Shoe Sizes

| Size | Small | Medium | Large |
|---------------------|------------|------------|------------|
| Ankle circumference | 14 - 29 cm | 22 - 40 cm | 30 - 45 cm |
| Calf circumference | 23 - 39 cm | 35 - 51 cm | 40 - 58 cm |
| Ball width | 10,5 cm | 12 cm | 13,5 cm |
| Shoe sizes | | | |
| EUR | 35 - 39 | 39 - 43 | 43 - 49 |
| UK | 2 - 5 | 4 ½ - 9 | 8 ½ - 15 |
| US (M) | 2 ½ - 5 ½ | 5 - 9 ½ | 9 - 15 ½ |
| US (F) | 4 ½ - 8 | 7 ½ - 12 | 11 ½ - 14 |

Recommendation: At the size interfaces between the Small/Medium and Medium/Large versions, supply the smaller VACOPed Diabetic size if possible.

Adjust Calf Circumference

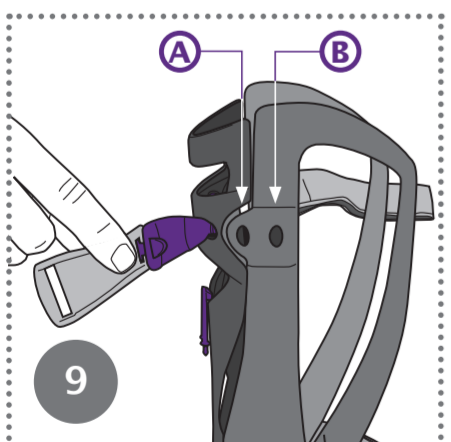

Push the buckle out of the lower shell and into the desired position.
A. Large calf circumference
B. Small calf circumference
Repeat on the other side.